

B 315

Wing nuts

Angular wing shape (American form)

Steel | zinc-plated | Cr(VI)-free | Metric thread

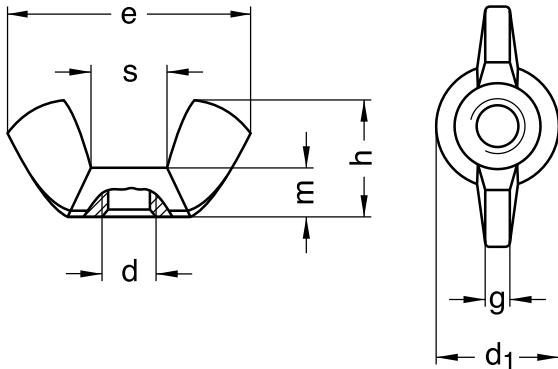

Diameter (d)	d ₁		g		e		h		m		s nominal size	Pitch (P)
	min.	max.	max.	min.	max.	min.	min.	max.	min.	max.		
M4	6.7	8.3	2.9	1.9	20.0	16.5	7.6	9.6	2.60	3.6	4.8	0.70
M5	8.7	10.3	3.1	2.1	23.5	20.5	9.5	11.5	3.50	4.5	6.2	0.80
M6	11.1	12.7	3.5	2.5	28.7	25.7	11.7	13.7	4.30	5.5	8.8	1.00
M8	12.6	14.4	3.8	2.8	32.0	28.6	13.6	16.0	4.80	6.0	9.1	1.25
M10	14.4	16.2	4.5	3.5	38.0	33.6	16.0	18.0	5.78	6.9	11.0	1.50
M12	19.5	21.5	5.5	4.5	50.0	45.0	21.0	24.0	7.30	8.5	14.4	1.75

All technical data refer to the measure mm

